

kadaster



Standardized work flow for processing survey data

Pieter Soffers

kadaster

Improving the link between survey documents and the Dutch cadastral map

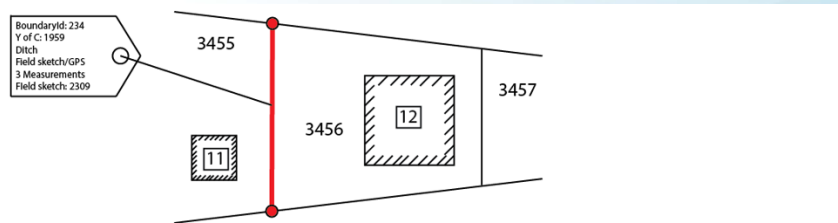

- BoundaryId: 234
- Measurement 1: Verification
- Measurement 2: Boundary reconstruction
- Measurement 3: Boundary reconstruction
- Field sketch
- Original survey data
- KAD1

Issues

- **Fragmented relation between survey data and the Dutch cadastral map**
- **Survey data is related to parcels instead of boundaries**
- **Different survey methods means different processing**
- **More accurate survey data is adapted to the less accurate Dutch cadastral map**
- **Every boundary have zero to multiple spatial sources:**
- **Survey data are stored at different places and in different formats**

Different processing

Boundary with
start- and endpoint



Boundary with
intersectionpoints



